

MANHOLE COVER

D400T/600_001

MODEL: ROUND

CLASS | D400

NORM | EN 124-5:2015

(test load 40 ton) Carriageways of roads including pedestrian streets, hard shoulders and parking areas, for all types of road vehicles.

RESIN: self-extinguishing orthophthalic

MATRIX: glass fiber

PROCESS ADDITIVES AND REACTION PROMOTERS:

various additives

MANUFACTURING PROCESS:

SMC compression molding with prepregs



COVER

D	mm 650
h	mm 40

FRAME

F	mm 785
C/O	mm 600
H	mm 100

WEIGHT

COVER	kg 30,5
FRAME	kg 13,0
TOTAL	kg 43,5

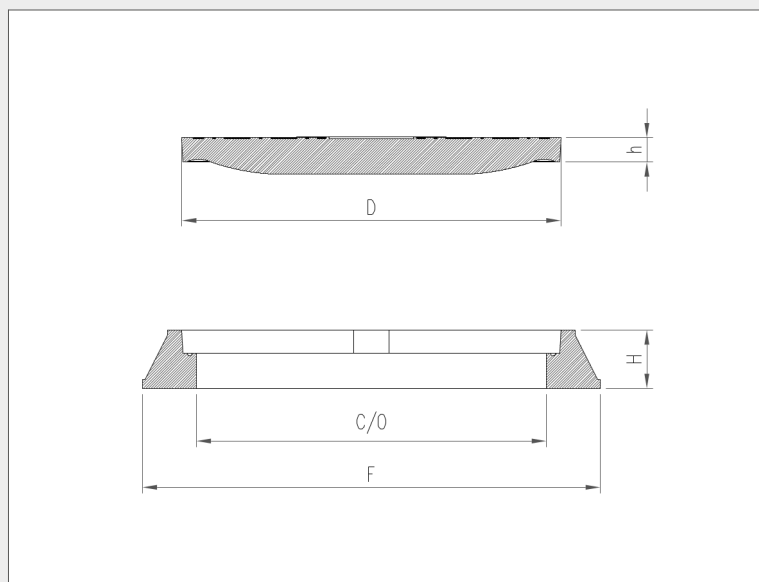

SURFACE DESIGN

14x14 square with T01 treatment

COLOUR

black RAL 9011

LIFTING KEY

type 2

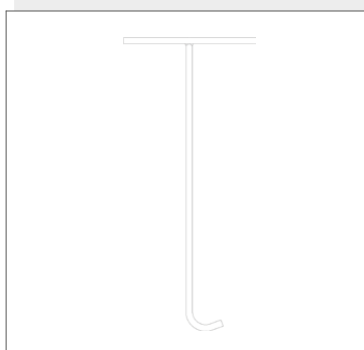

ACCESSORIES

LIFTING:
2 eye screws 2 washers 2 hexagonal nuts
FIXING:
1 screw TCE
SEALING:
yes (EPDM)