

MANHOLE COVER

D400Q/600_001

MODEL: SQUARE

CLASS | D400

NORM | EN 124-5:2015

(test load 40 ton) Carriageways of roads including pedestrian streets, hard shoulders and parking areas, for all types of road vehicles.

RESIN: self-extinguishing orthophthalic

MATRIX: glass fiber

PROCESS ADDITIVES AND REACTION PROMOTERS:

various additives

MANUFACTURING PROCESS:

SMC compression molding with prepregs



COVER

D	mm 655X655
h	mm 58

FRAME

F	mm 770X770
C/O	mm 600x600
H	mm 100

WEIGHT

COVER	kg 48,2
FRAME	kg 21,5
TOTAL	kg 69,7

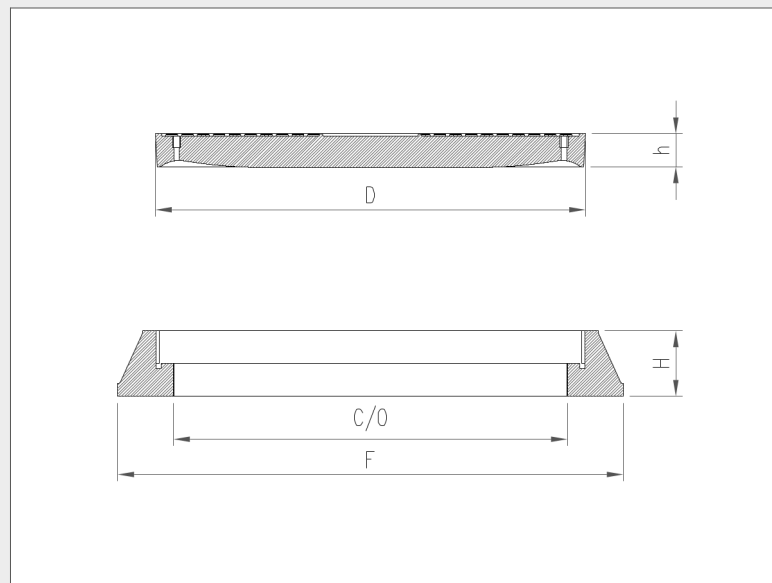

SURFACE DESIGN

14x14 square with T01 treatment

COLOUR

black RAL 9011

LIFTING KEY

type 2

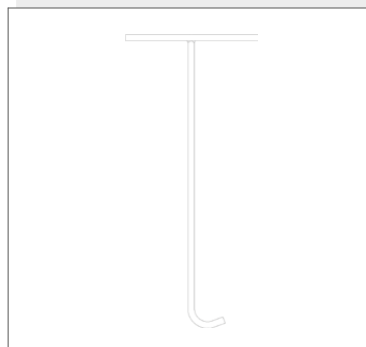

ACCESSORIES

LIFTING:

2 eye screws 2 washers 2 hexagonal nuts

FIXING:

4 screws TCE