

MANHOLE COVER

D400Q/550_001

MODEL: SQUARE

CLASS | D400

NORM | EN 124-5:2015

(test load 40 ton) Carriageways of roads including pedestrian streets, hard shoulders and parking areas, for all types of road vehicles.

RESIN: self-extinguishing orthophthalic

MATRIX: glass fiber

PROCESS ADDITIVES AND REACTION PROMOTERS:

various additives

MANUFACTURING PROCESS:

SMC compression molding with prepregs



COVER

D	mm 600X600
h	mm 50

FRAME

F	mm 705X705
C/O	mm 550X550
H	mm 100

WEIGHT

COVER	kg 34,0
FRAME	kg 19,0
TOTAL	kg 53,0

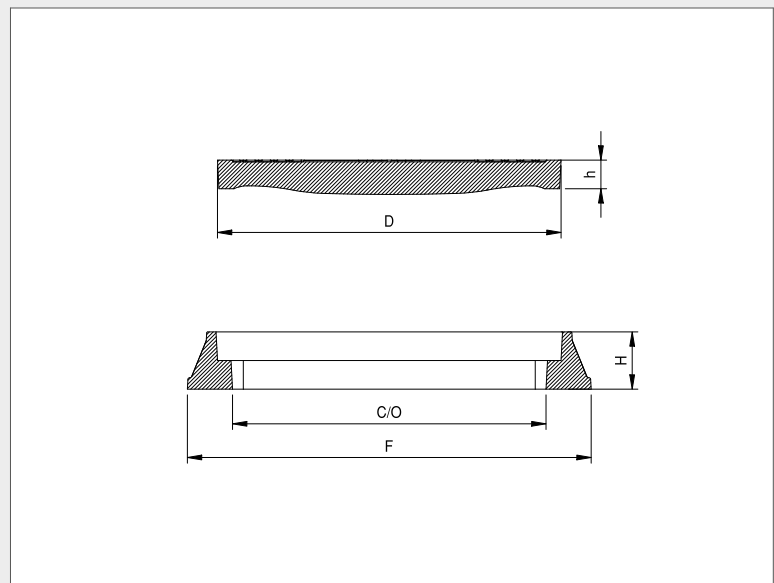

SURFACE DESIGN

14x14 square with T01 treatment

COLOUR

black RAL 9011

LIFTING KEY

type 2

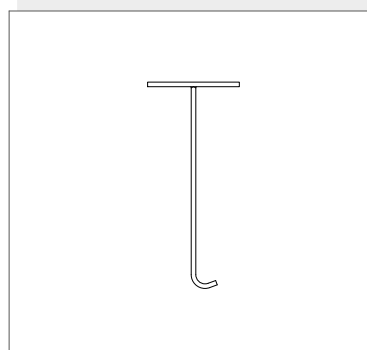

ACCESSORIES

LIFTING:

2 eye screws 2 washers 2 hexagonal nuts

SEALING:

yes (EPDM)