

MANHOLE COVER

C250TC/700_001

MODEL: ROUND

CLASS | C250

NORM | EN 124-5:2015

(test load 25 ton) For gully tops installed in the area of kerbside channels of roads which when measured from the kerb edge, extend a maximum of 0.5m into the carriageway and a maximum of 0.2m into the footway.

RESIN: self-extinguishing orthophthalic

MATRIX: glass fiber

PROCESS ADDITIVES AND REACTION PROMOTERS:

various additives

MANUFACTURING PROCESS:

SMC compression molding with prepregs



COVER

| | |
|---|--------|
| D | mm 750 |
| h | mm 50 |

FRAME

| | |
|-----|--------|
| F | mm 860 |
| C/O | mm 695 |
| H | mm 75 |

WEIGHT

| | |
|-------|---------|
| COVER | kg 39,7 |
| FRAME | kg 13,8 |
| TOTAL | kg 53,5 |

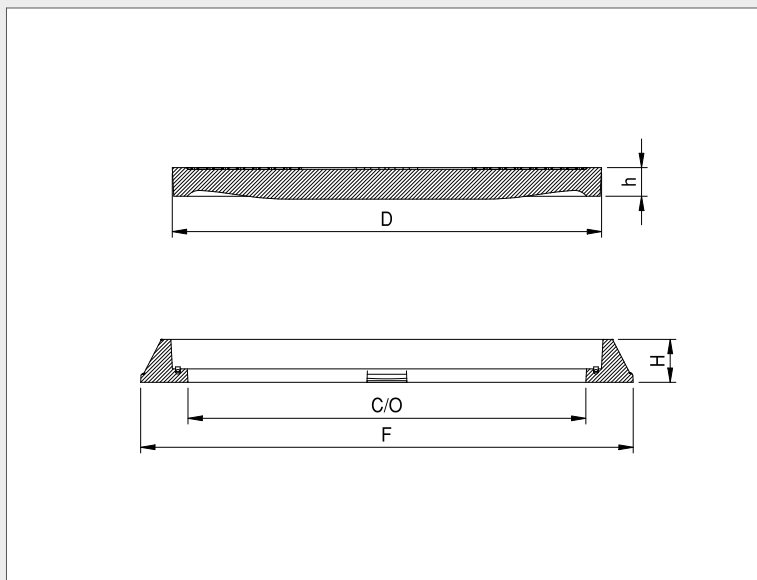

SURFACE DESIGN

14x14 square with T01 treatment

COLOUR

black RAL 9011

LIFTING KEY

type 3

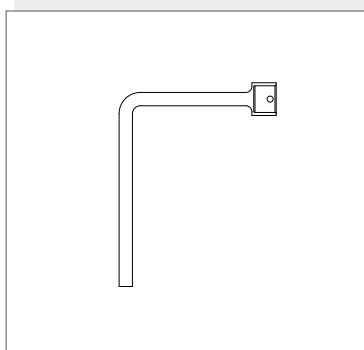

ACCESSORIES

FIXING:

1 hinge 120°+ lock

SEALING:

yes (EPDM)